

V-ARMOR SERIES SVEX-Q25-Z

Explosion Proof Smart CCTV Camera With Light



Features

- Stainless steel 304 or 316L
- Class I Div II
- Optional electropolished or corrosion resistant paint finish
- Enclosure Protection: IP68
- Exd II CT6 Gb/ Ex tD A21 IP68 T80°C
- Power input: DC12V or POE power supply
- Includes lights for night vision: 0-30m distance
- Application: Oil tank, dangerous goods vehicle, marine vesse

Dimensions:

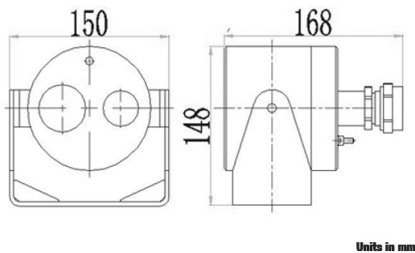

Optional Mount

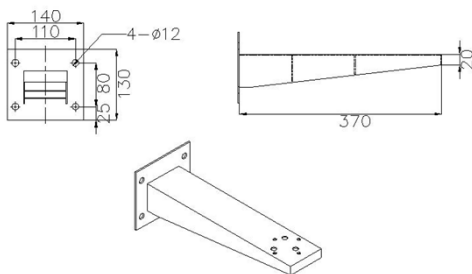

| | |
|----------------------------------|--|
| Atmospheric Pressure | 80KPa~110Kpa |
| Ambient Temperature | -20°C ~ +60°C |
| Relative Humidity | ≤95% (+25°C) |
| Ex-Proof Mark | Exd II CT6 Gb/ Ex tD A21 IP68 T80°C |
| Classification | Class I Div II |
| Explosion Proof Certified | CNEx 16.2526 |
| Ingress Protection | IP68 |
| Housing Material | Stainless Steel 304 or 316L |
| Image Sensor | 1/3" Progressive Scan CMOS |
| Signal | PAL/NTSC |
| Effective Pixel | 1920 x 1080 (HD type) |
| Min. Illumination | 0.01Lux @ (F1.2, AGC ON), 0 Lux with IR |
| SHUTTER | 1/3 sec to 1/100,000 sec |
| Lens | 4mm (6mm optional) |
| Lens Mount | M12 |
| Day & Night | IR cut filter with auto switch |
| Horizontal Resolution | 1920x 1080 |
| Video Output | 1 RJ45 10M / 100M ethernet interface |
| S/N Rate | above 62 dB |
| Auto Gain | Lower/ middle/ high/ off |
| Color | Color/ B&W / IR |
| White Balance | auto/ manual |
| Private Protect | on/off, 8 zones |
| Move Detection | on/off, 4 zones |
| Exposure | total exposure/ wide balance |
| 3D Noise | lower/ middle/ high/ off |
| Function | Smart IR contrast, Sharpness, saturation, mirror, zoom |
| Light Night Vision | 0-30m |
| Voltage Input | DC12V/ POE |
| Power Consumption | 5W Max |
| Cable Output | Integrated cable, 2m long |
| Cable Gland | 1pcs G3/4 |
| Overall Dimension | 168 x 150 x 148 (L x W x H) |
| Net Weight | 4.3 kg |
| Material | Stainless steel 304 or 316L |
| Max Loading | 20kg |
| Weight | 1.8kg |